



KODACHAIR

DALBRANDS

BRINGING MOVEMENT TO YOUR WORKPLACE



DAL
BRANDS



SUPPORT FOR A RANGE OF POSTURES

“

It is no longer good enough for a chair to just have some adjustments – it is essential that your chair can provide support for you in a range of postures.

Each workplace is different, we are all different, and we work in different ways. Our chairs must be able to offer support for us in a variety functional postures.

Koda has been designed with this in mind, it moves easily with you, and importantly it is easily adjusted from the seated position.

“Comfort” and first impressions are often lasting – our PostureSoft® foam seat is multi-layered to provide great support whilst maintaining a lasting level of comfort

We also back Koda with testing and certifications to give you confidence in the environmental and compliance aspects of the chair

We are sure you will enjoy Koda.

”



DAL
BRANDS

KODA



10 YEAR
GUARANTEE

5 YEAR
GUARANTEE
8HRS+



DYNAMIC ERGONOMICS

We need to fulfil our body's desire to vary our posture during the day. We can only do this if our chair follows our needs.

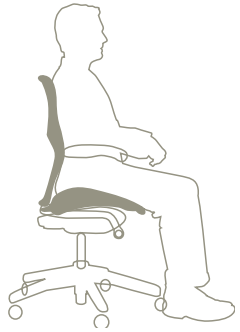

Koda is a well-balanced chair – simply adjust the tilt tension to suit your weight and the chair will follow your movements without you needing to think about it.



We often lean back when we take a phone call, or sit up to the desk when using a computer. The Synchronised action of the seat and back as you lean back and forward keeps you supported without having to consciously adjust the chair.



The PostureSoft® seat design doesn't trap you in one spot, you can easily move around, whilst still having the right Comfort and Support.

KODA FAMILY

The KODA chair provides a complete seating solution. The easily adjustable, aesthetically ergonomic design, along with the simplicity of the desk chair and the versatility of the side chair, present a unified range of comfortable seating.



ERGONOMIC CONCEPT

AFRDI-142 Multi Shift and Level 6

Comfortable reclining is another remarkable feature that makes KODA such a pleasure to sit in. KODA's tilt reclining mechanism naturally follows bodily movement even while working at a computer. Ease of operation and easy to use controls enable the user to adjust seat height and reclining angle to their natural posture.

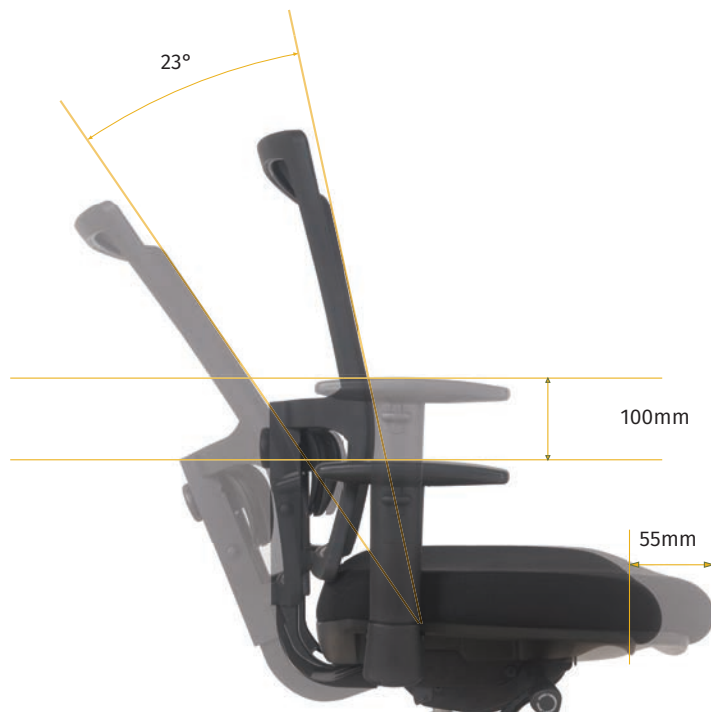

AFRDI-142 CERTIFIED

Tested and certified to AFRDI 142 MS Rated Load Standard and AFRDI Level 6 Severe Commercial Use which covers Strength, Durability, Ergonomics and AS/NZS Standards, you can have peace of mind that KODA will handle the most demanding situations. The Koda mesh back is ultra- strong and also rated for 24 hour use applications.

This provides assurance in high use applications and where the users may be above average weight.

Guaranteed to 160kg.



DAL
BRANDS

KODA



10 YEAR
GUARANTEE

5 YEAR
GUARANTEE
8 HRS+





DESIGNED TO FIT YOU

It seems obvious — your chair should fit you. But that, right there, is the key. The chair should fit you, not the other way around. With its intuitive adjustments, KODA easily conforms to fit you and works at its maximum capacity to provide you with a more comfortable sitting experience.

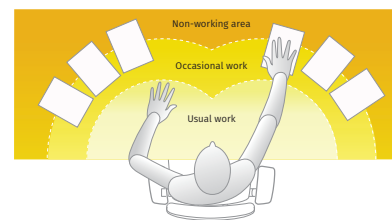

ADJUSTABLE 'T' ARMRESTS

The KODA armrests are cleverly positioned to allow them to be used even when sitting up to the workstation or desk. By locating the arms further back, your body will usually make contact with the front edge of the desk before the arm rests. The soft polyurethane has been chosen to provide greater comfort whilst being used. As well, the arms are both height and width adjustable.

POSTURE SOFT® MULTI DENSITY SEAT FOAM

All KODA chairs have a multi layer foam seat; the upper layer is softer comfort foam, and the lower layer more dense supportive foam. The comfort you first get when you sit down is maintained over time with the supportive foam designed to provide ongoing comfort.

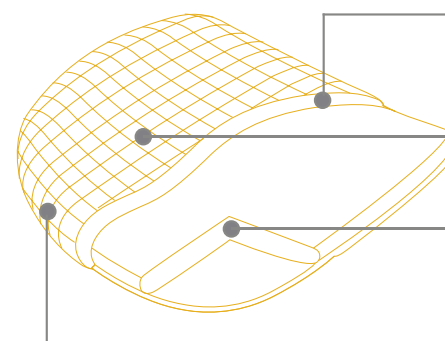

COMFORT LAYER

Softer layer of foam to ease any pressure areas, provides a more even support.

SHALLOW "DISHING"

Encourage more dynamic sitting

SUPPORT LAYER

Dense supportive foam

WATERFALL FRONT

Reduce pressure on the thighs

LUMBAR SUPPORT

An adjustable lumbar support is integrated into the height adjustable backrest. You are able to position the lumbar at the height to suit your body, and with the simple depth adjustment you can set it to suit your personal requirements. Having good lower back support with the contour mesh backrest provides a very comfortable and supportive chair.

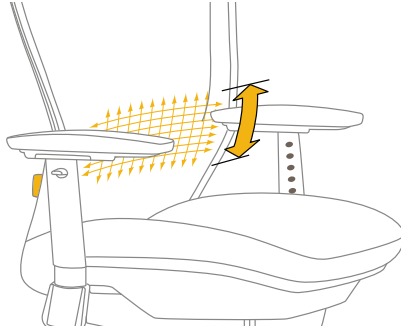

SYNCHRO ADJUSTMENT

This synchro style mechanism has all the benefits of a tilting chair mechanism plus a sliding seat and lumbar adjustment. It allows the user to further “fine-tune” the control to find a more comfortable posture. It also allows a deeper recline of the seat back to further reduce back stress while maintaining effective lumbar and thigh support.



DAL
BRANDS

KODA



MESH BACK

The mesh back on the KODA is made for comfort, whilst providing good lower back support it has a back height designed to provide support even when the chair is in the reclined position. With height adjustment easily operated from the seated position you can set the back height as required.

ADJUSTABLE CONTROLS AND ERGONOMIC SUPPORT

The right ergonomic seating meets you wherever you are—and can adjust to wherever you move. KODA offers a wealth of features that ensure full adjustability from top to bottom and back to front

LUMBAR SUPPORT

The contoured lumbar pad can be easily adjusted for personalized lumbar support and ergonomic comfort.

BACKREST HEIGHT

Push the back height button from the seated position to adjust the backrest height.

LUMBAR DEPTH ADJUSTMENT KNOB

Turn to increase or decrease lumbar support.

ARMRESTS

Easy to use height adjustable arms with polyurethane arm pads.

GAS LIFT LEVER

For seat height adjustment

MESH BACKING

Allows air to pass freely, making it comfortable in all environments. It also boasts dynamic movement- in other words, it moves with you.

PostureSoft® foam

Provides great support whilst maintaining a lasting level of comfort.

TURN LEVER TO FRONT -
Mechanism is free floating.

TURN LEVER TO BACK -
Mechanism is locked.

SEAT DEPTH LEVER

Lift the lever to adjust the seat depth.

SEAT TILT TENSION ADJUSTMENT KNOB

Turn to increase or decrease tension.

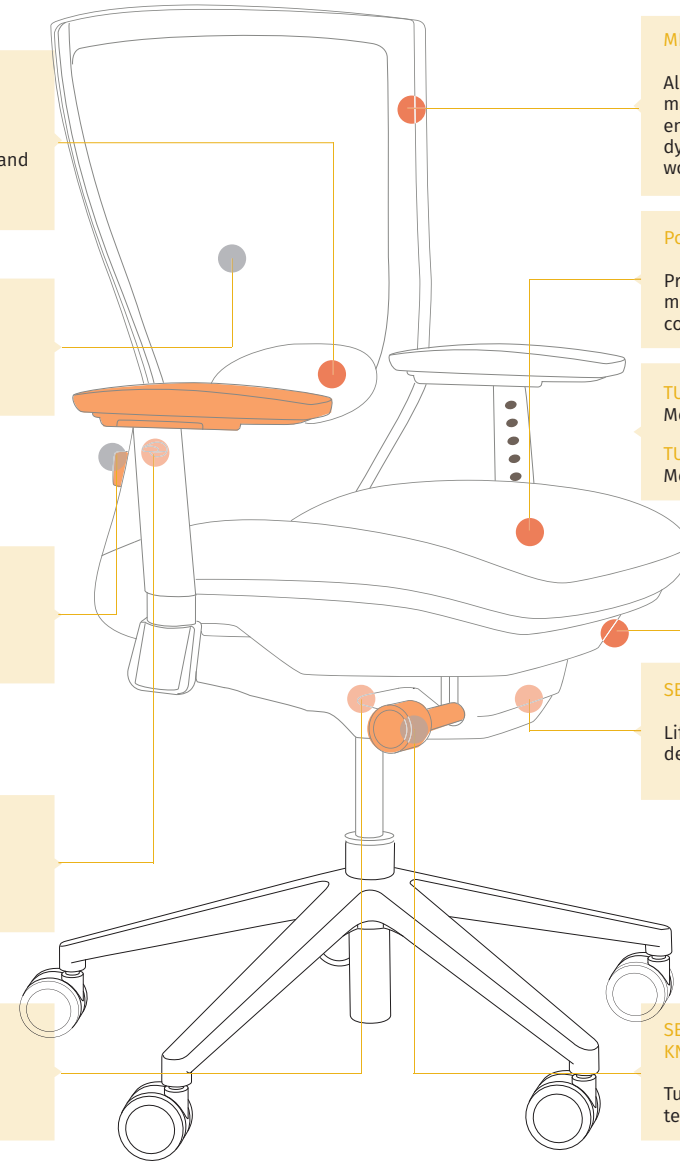

KODA GUEST CHAIR

VISITORS HAVE REQUIREMENTS TOO. THAT'S WHY KODA OFFERS THE SAME
LEVEL OF DESIGN AND COMFORT THROUGHOUT THE RANGE.

KODA GUEST chairs have a soft upholstered seat and mesh backrest. This completes the KODA line as a solution for waiting and conference areas. Light and comfortable with four chrome plated legs. KODA GUEST chairs are ready to be stored in a stack to save space while waiting for your next meeting.



STACKABLE

all KODA visitor chairs are stackable to
save space



DAL
BRANDS

KODA

ENVIRONMENTAL MATERIALS BREAKDOWN

MATERIAL TYPE	CHAIR COMPONENT	RECYCLED CONTENT (%)	RECYCLABLE AFTER USE (%)
Plastic (26.3%)	<ul style="list-style-type: none"> • Castors (0.2kg) • Seat Frame (0.6kg) • Lumbar Support (0.1kg) • Back Outer Frame (2.17kg) • Nylon Base (1.8kg) 	3% 1%	99.5% RECYCLABLE
Steel (56.9%)	<ul style="list-style-type: none"> • Arm Upright Pipe (2.28kg) • Gas lift (1.22kg) • Seat Mechanism (5.0kg) • Screw & Bolts & pentals (0.5kg) • Back Bracket (1.56kg) 	0%	
Plywood (8.1%)	<ul style="list-style-type: none"> • Seat Plywood (1.5kg) 	0%	
Foam (8.2%)	<ul style="list-style-type: none"> • Seat PU Foam (0.8kg) • Other Foam (0.72kg) 	0%	
Upholstery (0.5%)	<ul style="list-style-type: none"> • Upholstery Fabric & Mesh (0.1kg) 	0%	0.5% NON RECYCLABLE
Packaging (100%)	<ul style="list-style-type: none"> • Cardboard Carton & Internal Packaging (1.0kg) • Plastic Bag (0.1kg) • Recycled Paper (0.1kg) • Strapping • Tape (0.05kg) 	88% 0% 90% 0% 0%	100% RECYCLABLE

GREENTAG CERTIFIED

Providing not only a good ergonomic seating, but also a responsible environmental choices is an integral part of our philosophy. As an environmentally responsible company we are taking active steps to ensure the products we offer are carefully selected, not only for design and function, but just as importantly for the effect they have on our environment.



GUARANTEE FINE PRINT

KODA OFFICE CHAIR

The guarantee covers faulty workmanship and materials for 10 years* from the date of manufacture; the guarantee does not cover fair wear and tear, or the chair upholstery.

The guarantee is a "back to base" guarantee. You need to return the chair to the place of purchase, and any faulty parts will be replaced free of charge.

Should you require your chair repaired on site you will be subject to a service charge, you can call your place of purchase for an estimate of the cost to complete repairs on site.

NB: This guarantee does not cover freight costs, or on site labour costs. Labour costs are covered if the chair is returned to the place of purchase.

*5 year intensive use 8 hrs+



DAL
BRANDS

KODA

STANDARD COLOURS & FINISHES

All the standard finishes used for KODA meet the similar standards required for the finishes on the automobiles in non-flammability and anti-abrasion.

KODA Chair

Basic model:

- Synchronised tilting mechanism
- Tilt lockable 4 positions
- Sliding seat depth adjustment
- Adjustable lumbar support
- Back height adjustment
- Height adjustable arms
- Width adjustable arms
- Tilt tension adjustment
- 60mm castors for carpet floors
- Posture Soft™ seat foam
- Spring tension to suit 70 kg+ user
- Aluminium Base (AFRDI 142 Multi Shift certified)

Options

Armrests with sliding top
Mechanism to suit body weight 50-70kg
60mm PU castors for hard floors
Black Nylon Base
No Arms

KODA Guest Chair

Basic model:

- Chrome 4 leg frame
 - Arm pads
 - Mesh backrest
 - Fully upholstered seat
 - Stackable - 4 high
- *(Stocked only in black other colours POA - 8 weeks)

Backrest



Seat



ICON Black



ICON Grey



ICON Blue



10 YEAR
GUARANTEE

5 YEAR
GUARANTEE
8 HRS+



DIMENSION NOTES

All dimensions in mm

Measurements are not absolute, small variations exist from chair to chair
(F) (3) measured with backrest vertical, i.e. no change in seat depth as backrest is moved up and down
(10) backrest width measured at widest point
(7) (6) measured from the centre part of the seat in a horizontal position

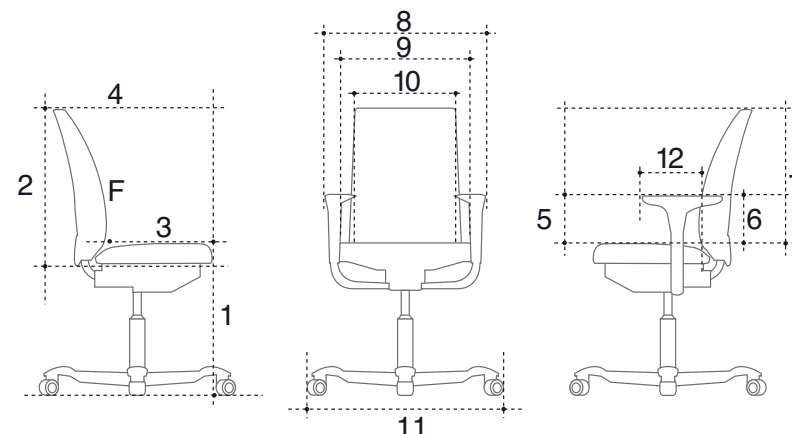

DIMENSIONS

KODA CHAIR

Seat height	465-600
Seat depth from lumbar F with seat slide (3)	425-480
Seat depth overall (4)	475
Seat slide adjustment range	55
Seat width overall (8)	480
Armrest height above seat (5)	160-260
Width between armrests (9)	480-520
Armrests depth from F (12)	215
Height of backrest overall (2)	580
Height of backrest above seat (7)	580-660
Height of forward-most point of backrest F (6)	200-280
Back height adjustment range	80
Width of backrest (10)	470
Foot Base Diameter (11)	680





DALBRANDS.COM.AU

23 TOVA DRIVE, CARRUM DOWNS VIC 3201
PHONE +61 3 9775 1622 FAX +61 3 9775 0325

© ALL RIGHTS RESERVED DAL BRANDS 2015